

208,560 SF

State-Of-The-Art Cold Storage Facility

Delivering Q1 2025



Located at
INNOVATION BUSINESS PARK BUILDING 9
HUTTO, TX



PROPERTY FEATURES

- Building size: 208,560 SF (Divisible to 50,000 SF)
- Clear height: 50' clear in the freezer – 30' clear in the cold docks
- Convertible storage area: 156,000 SF
- Auto parking spots: 148
- Trailer stalls: 35
- Refrigerated dock area: 43,680 SF
- 30' clear in the loading bay/cold dock area

- Two – 3,600 SF single story offices
- 40,000 lb vertical dock levelers (7'x6'), trailer restraints, electrically operated doors, master control panels, and dock seals

COLD STORAGE AMENITIES

- # pallet positions: 34,000 pallets (Approx.)



50'
CLEAR HEIGHT



-20°F / 40°F
CONVERTIBLE STORAGE



35
TRAILER SPOTS

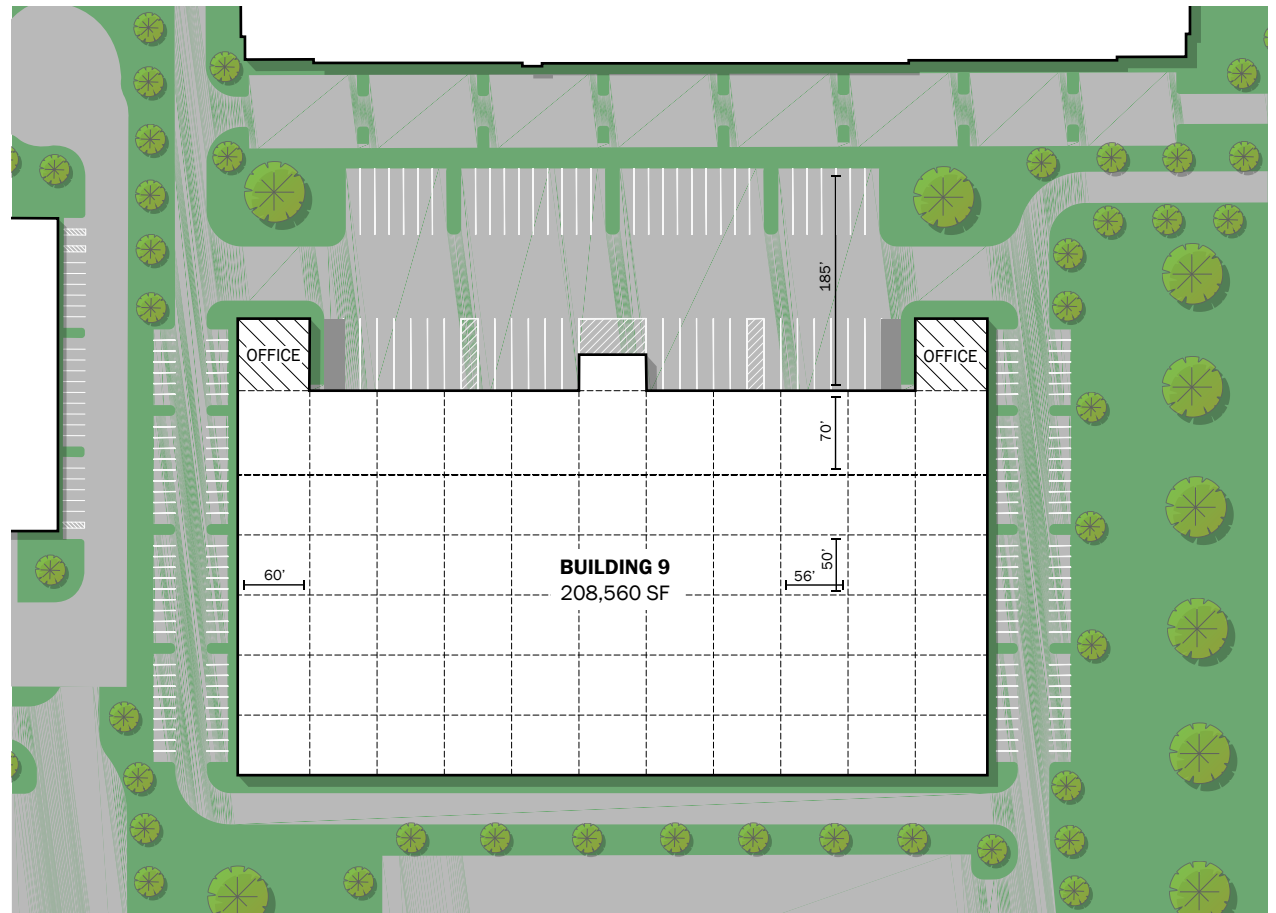

OVERALL SITE PLAN



FOOD & BEVERAGES MANUFACTURER MAP

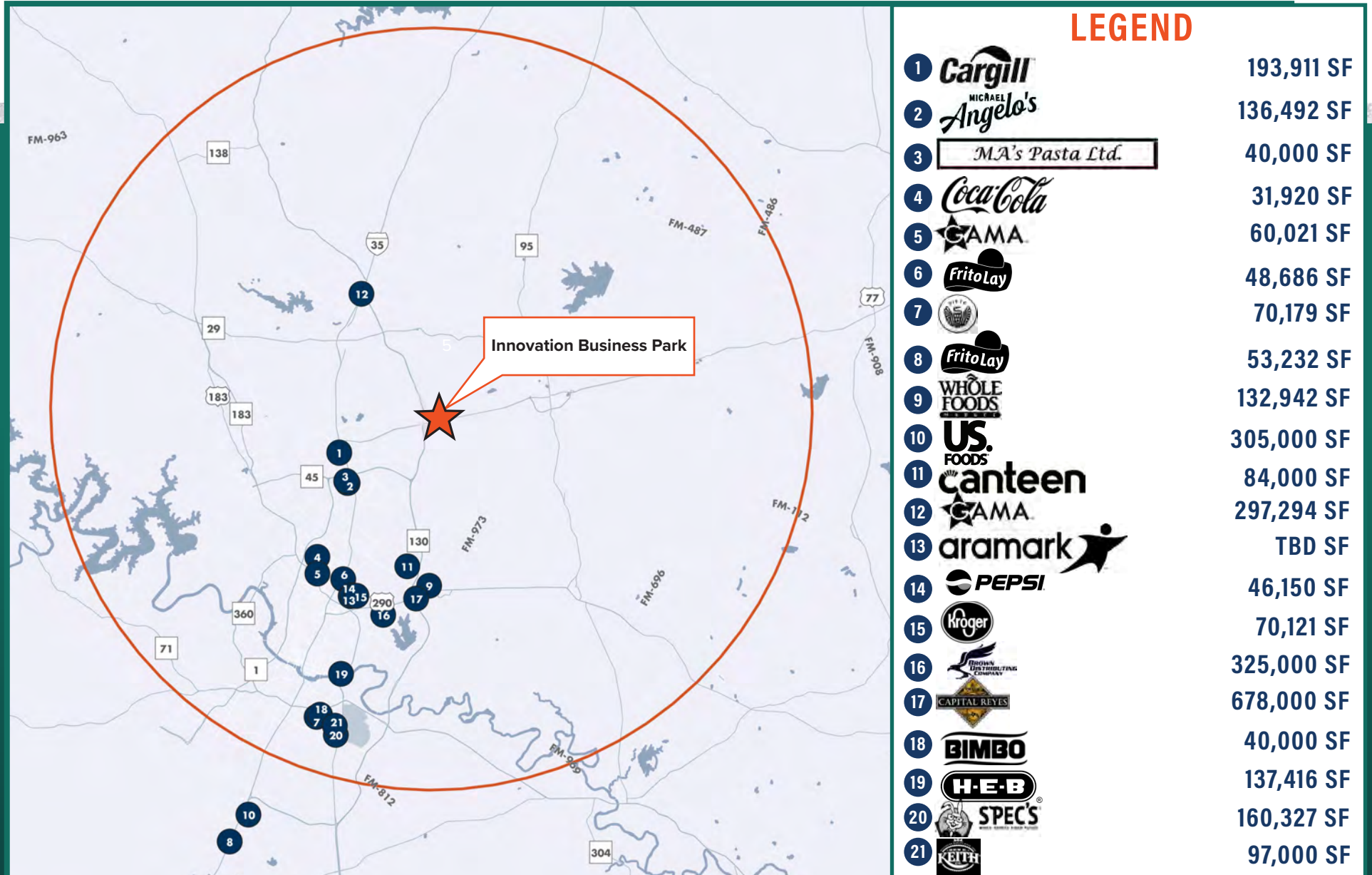

DRIVE TIME

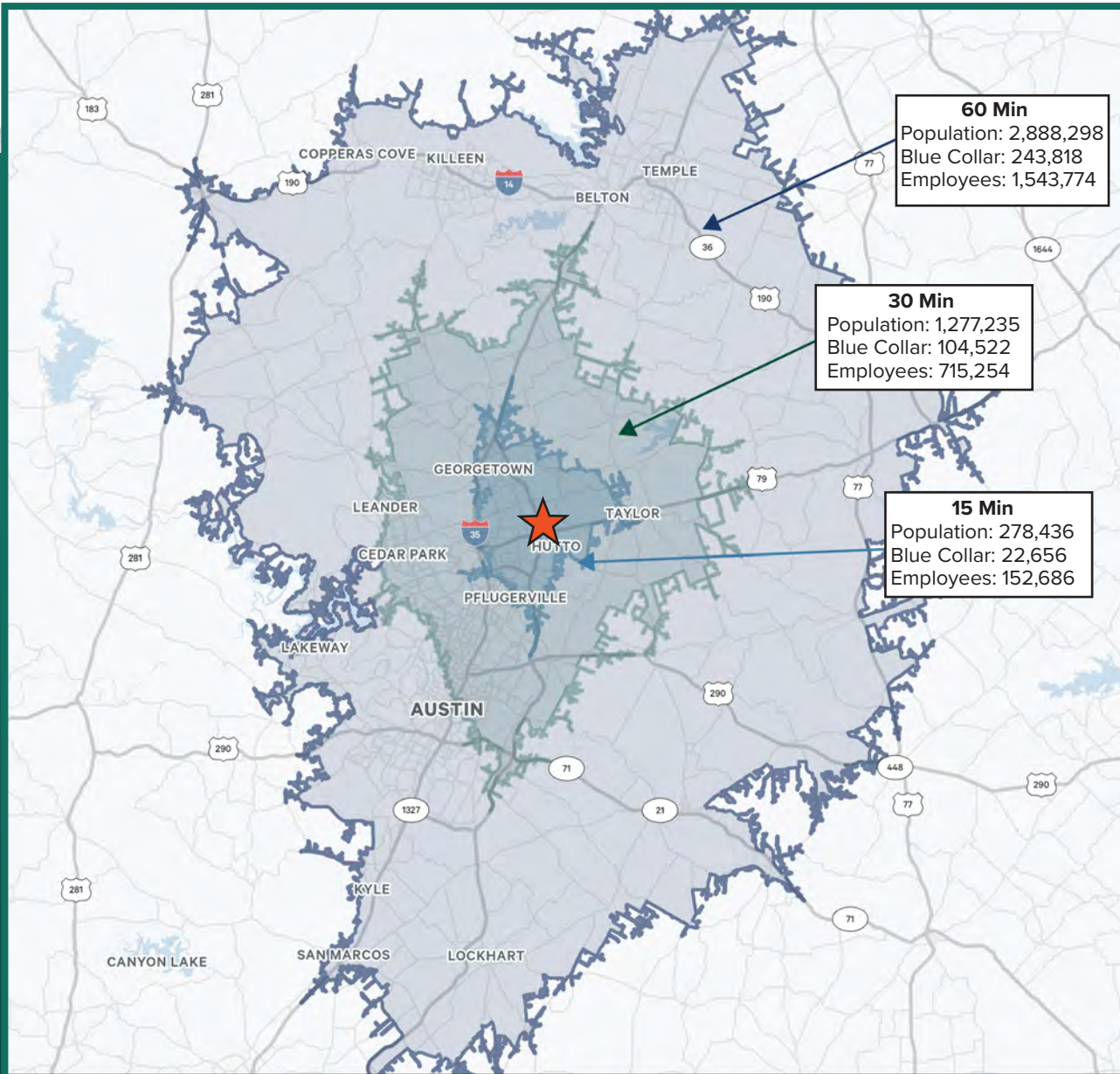

Hutto Community

Innovation Business Park is located at the corner of Innovation Blvd and Limmer Loop in Hutto, Texas

- + Hutto is part of Austin/Round Rock MSA, with an employable population of over half-million
- + City is fast-growing suburb, located less than 30 minutes from downtown Austin - the 11th largest city in US and 4th largest city in Texas
- + Hutto is a known transportation hub
- + Austin-Bergstrom International Airport is 30 miles south of Hutto
- + 12 miles away from Austin Executive Airport
- + Easy access to both SH-130 and SH-79

ACCESS MAP

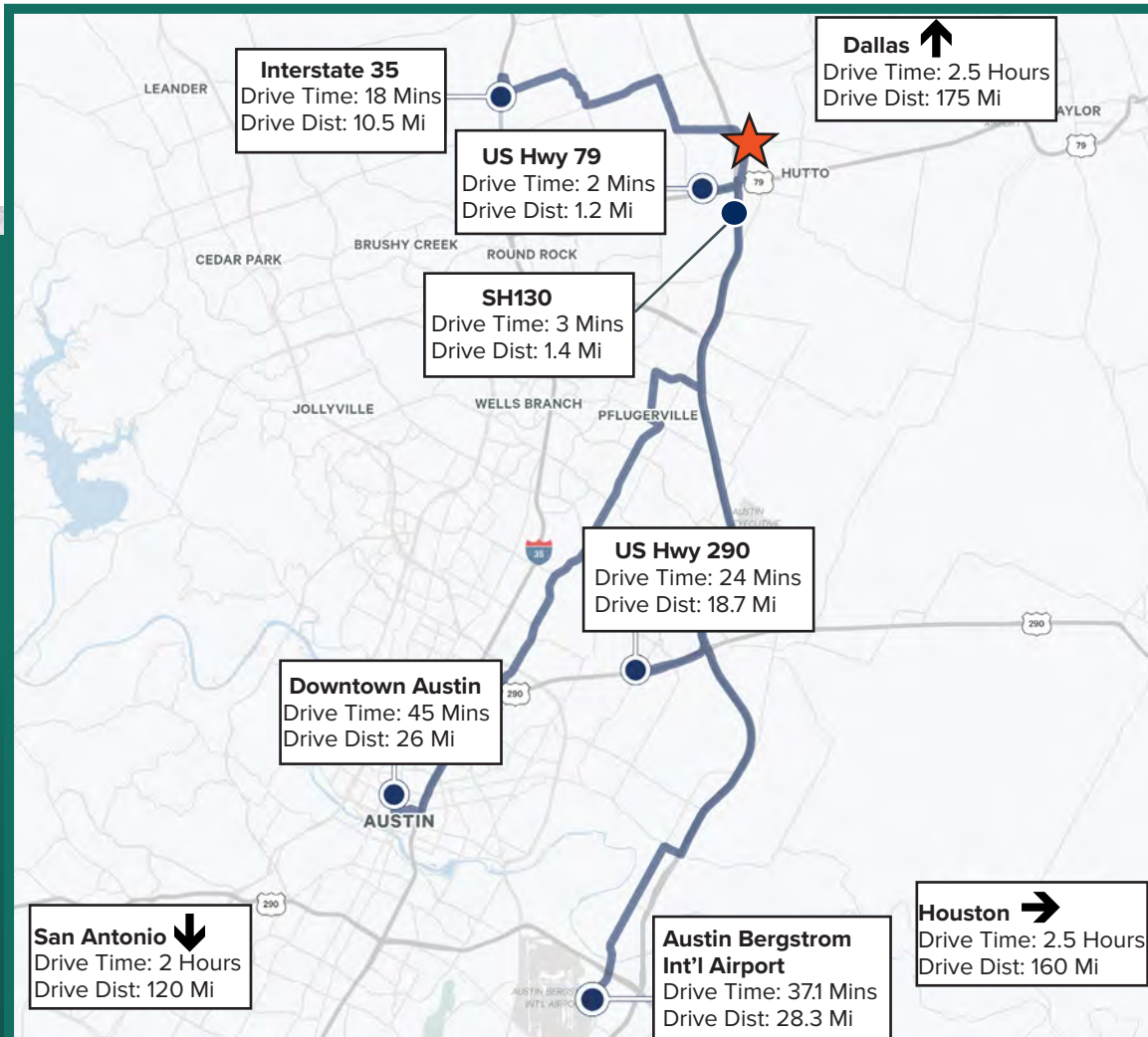

Prime Location

- + Hutto is one of the fastest-growing cities in Texas
- + Majority of Hutto's population is of working age, between ages of 18 and 65, with median age of 33 years old
- + Within 5 years, Williamson County's net annual population growth will overtake Travis County
- + 581,027 population within 15 miles

Population Projections (Williamson County)

2010	422,679
2020	589,914
2030	830,421
2040	1,175,338
2050	1,645,982

PHH Income

\$88,161

median hh
income

43%

residents greater
than \$100,000

61%

residents greater
than \$75,000

FOR ADDITIONAL INFORMATION CONTACT:

JASON LEV

Executive Vice President

+1 847 706 4044

jason.lev@cbre.com

OMAR NASSER, SIOR

Principal

+1 512 684 3721

nasser@aquilacommercial.com

JOHN SUERTH, SIOR

Executive Vice President

+1 847 706 4929

john.suerth@cbre.com



© 2024 CBRE, Inc. All rights reserved. This information has been obtained from sources believed reliable, but has not been verified for accuracy or completeness. Any projections, opinions, or estimates are subject to uncertainty. The information may not represent the current or future performance of the property. You and your advisors should conduct a careful, independent investigation of the property and verify all information. Any reliance on this information is solely at your own risk. CBRE and the CBRE logo are service marks of CBRE, Inc. and/or its affiliated or related companies in the United States and other countries. All other marks displayed on this document are the property of their respective owners. Photos herein are the property of their respective owners and use of these images without the express written consent of the owner is prohibited. PMStudio February_2023

